

OCEAN PATRIOT



Midwater
Moored
Semisubmersible

GENERAL DESCRIPTION	
Design	Trosvik, Bingo 3000
Year Entered Service	1983
Classification	ABS, +A1 Column Stabilised Drilling Unit
Main Deck	246ft (75m) Long x 206.6ft (63m) Wide
Draft	77ft (23.5m) Drilling, 36ft (10m) Transit
Displacement	33,010MT
Variable Deck Load	3,500MT Drilling / 3500MT Transit
Transit Speed	4 knots
Water Depth	1,476ft (450m) - outfitted
Drilling Depth	20,000ft (6,096m)
Accommodation	120 people
Helideck	Sikorsky S-92, CAP 437 compliant + d rating

DRILLING EQUIPMENT	
Derrick	Unite D'ingen 160, 185 ft high with 40ft x 40ft base, hook load capacity of 1,000kips
Drawworks	Oilwell E-3000, 2400hp
Compensator	NOV Shaffer 25-600 600 kips capacity with 25ft stroke
Rotary Table	Oilwell A-495, 49-1/2", 650ST
Top Drive	Varco TDS-8SA, 650T
Tubular Handling	2x Varco HT100 4" - 12" 1x Varco AR3200 Iron Roughneck 3-1/2" - 9-1/2"
Fingerboard Capacity	DP - 29,1760ft (216 Stds) 5-1/2"OD DC - 945ft (7 Stds) of 8" OD DC - 945ft (7 Stds) of 9" OD
Mud Pumps	3x National 12-P-160, 1,600hp, 5000psi
Shale Shakers	3x NOV VSM Multisizers

CRANES	
Deck Cranes	1x 50T Liebherr Bos 50/1500 with 142ft boom 1x 68T Seatrax s9028 with 140ft boom
Pipe Handling	1x PKM700T Knuckle Boom Crane

STORAGE CAPACITY		
Liquid Mud	2,288 bbls	364 m³
Mud Storage Tanks	2x 1,000 bbls	2x 159 m³
Base Oil	2,072 bbls	329 m³
Brine	2,227 bbls	354 m³
Bulk Barite/Gel	6,710 ft³	190 m³
Bulk Cement	10,000 ft³	283 m³
Sack Storage	270T	135 m³
Fuel	13,020 bbls	2,070 m³
Drill Water	6,711 bbls	1,067 m³
Potable Water	2,861 bbls	455 m³

SUBSEA EQUIPMENT	
Diverter	Regan KFDS-3 20" 500 psi diverter with 14" flow line
BOP Stack	Hydril 18 ¾" 15,000 psi five-ram preventer 2x Cameron DL 18 ¾" 10,000 psi annular preventers, APIS53 compliant
C&K Manifold	3-1/16", 15,000 psi
Marine Riser	NOV DTI, 50ft long per joint
Tensioners	12 x 80 kips Shaffer wireline riser tensioners. Total capacity 960 kips with 50 ft. of wire travel
Moonpool	20 ft. x 72 ft 1x 60T Auxiliary Cart

POWER GENERATION	
Main Power	4x EMD diesel engines rated at 2000kW
Emergency Power	1x Caterpillar 3412D electric rated at 520kW

STATION KEEPING / PROPULSION SYSTEM	
Mooring System	8x 3.25" x 5,200 ft. RQ4 chains 8x 12T Stevpris anchors

OTHER INFORMATION	
Mud Recovery	Riserless Mud Recovery System
BOP Tethering	BOP anchor points
Coil / Wireline	Coiled Tubing Lifting Frame

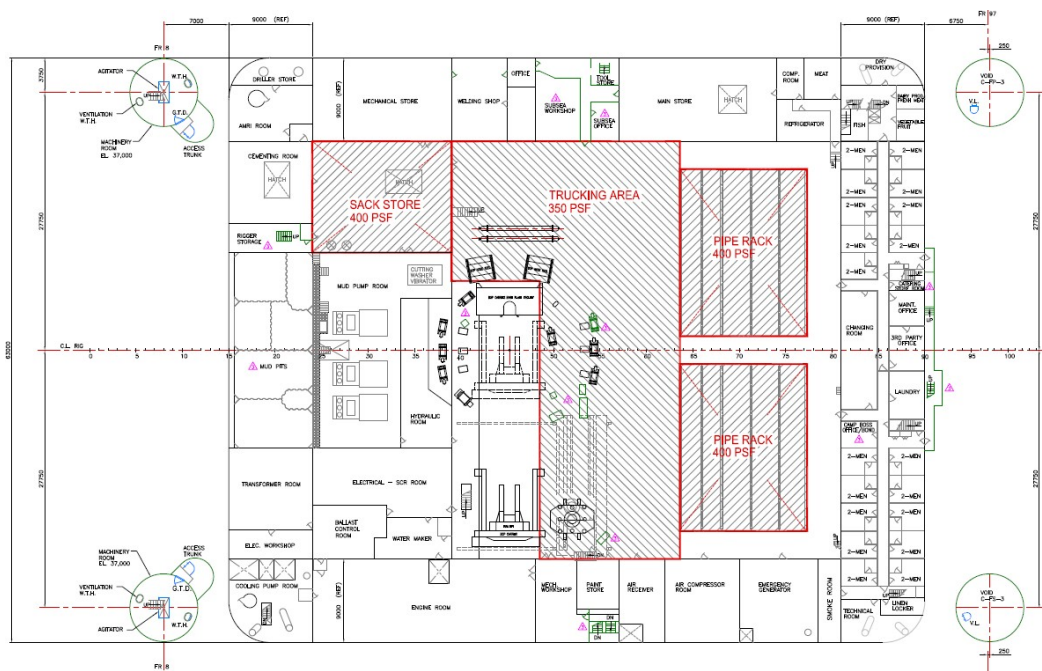

MAIN DECK & ACCOMMODATION DECK
LEVEL 1 - DECK NO. 10
G.L. 36,000 A.B.L.